

# 482.3.501

## DC motor performance

# DOMEL®

### Technical data:

DC motors 482.3.501/ 55W/ 24V DC are designed for incorporation into various household appliances such as sewing machines, coffee mills, mixers, food processors, etc. where small dimensions, low weight, high power and long life are requested. Technical data and dimensions are given in the table. Our DC motors can operate in different positions. Shaft can also be adapted to customers needs. The motors is constructed according to EN 60335-1.

Code:	482.3.501
Voltage/frequency:	24 V DC
Rated input power:	55 W
Rated speed:	9300 min <sup>-1</sup>
Rated output power:	41 W
Rated torque:	4,2 Ncm / 6 oz-in
Direction of rotation:	CCW
Type of operation:	30 min "ON" 30 min "OFF"
	continuous
Ventilation:	without
Mass:	0,31 kg

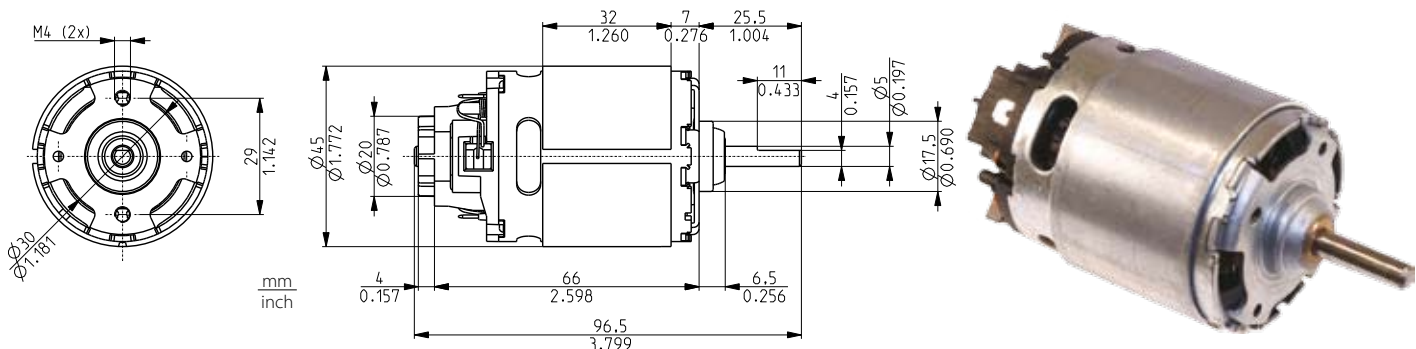

Dimensional and performance data are subject to change without notice.

Voltage	Current	Input Power	Speed	Torque		Output power	Efficiency
				Ncm	oz-in		
V	A	W	min <sup>-1</sup>			W	%
24	0,58	13	10200	0,0	0,0	0	0,0
24	1,03	24	10020	1,0	1,4	10	43,6
24	1,43	33	9820	2,0	2,8	21	62,5
24	1,86	43	9598	3,0	4,2	30	70,0
24	2,27	53	9414	4,0	5,6	39	74,6
24	2,37	55	9348	4,2	6,0	41	75,2
24	2,71	63	9198	5,0	7,1	48	76,6
24	3,13	73	9018	6,0	8,5	57	78,0
24	3,56	83	8809	7,0	9,9	65	78,0
24	3,99	93	8596	8,0	11,3	72	77,6
24	4,41	103	8391	9,0	12,8	79	77,2
24	4,84	112	8141	10,0	14,2	85	76,0
24	5,24	122	7976	11,0	15,5	92	75,0
24	5,70	132	7657	12,0	17,1	97	73,0
24	15,30	357	2372	33,3	47,1	83	23,2

Data above represent the performance of an average motor sample. Individual data may vary due to normal manufacturing variations.